

FLAT CLINCH

MAX

Heavy Duty Electronic Stapler EH-110F

EH-110F can staple with precision up to

110 sheets
(64gsm)

100 sheets
(80gsm)

of paper.

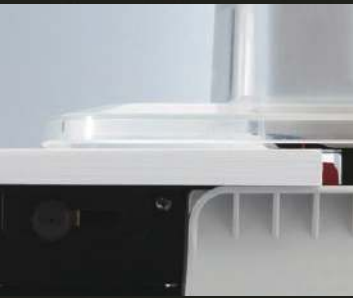

Made in Japan

"Auto cutting staple legs"
and *"Flat Clinch"*
mechanisms provide a beautiful stapling finish.

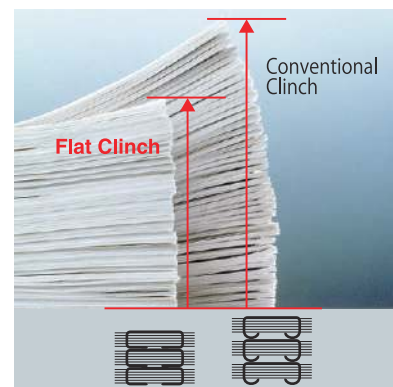
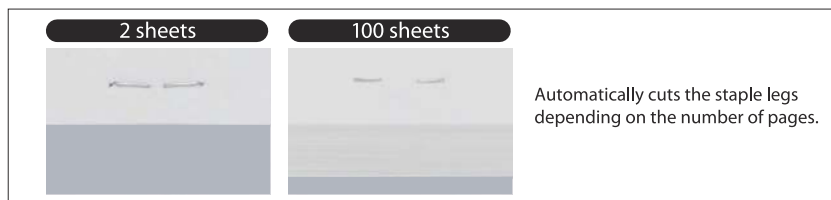

EH-110F provides you with professional-quality stapling.

Auto & Manual stapling switch

It is possible to select between "Auto-stapling" and "Manual-stapling" using the selector switch.



LED indication lamp

Easily know when you need to replace/clear/feed staples by the color and flash of the LED indication lamps.

User-friendly paper table

Wide paper table prevents papers from being dropped or bent. Guide lines help you staple at suitable positions and equal intervals.



Clear case

The actual stapling position clearly from any angle.

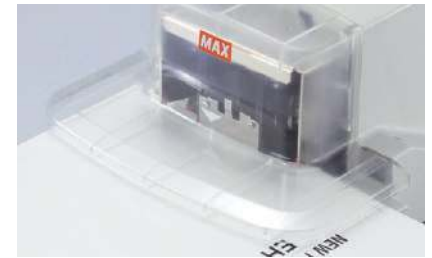

Adjustable stapling depth

Stapling depth has an adjustable range of approx. 3 to 23mm (1/8" to 7/8").

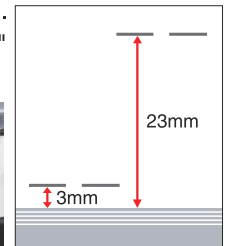
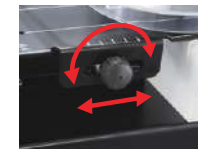

Reusable staple cartridge uses staple refills

New staple cartridge is reusable and you only need to replace staple refills No.110FE. One refill can staple 4,000 times.

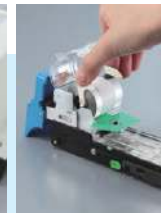

Easily clear jammed staples.

SPECIFICATIONS

Model Name	EH-110F
Capacity	2-110 sheets (64gsm paper), 2-100 sheets (80gsm paper)
Stapling speed	2 staples per second (0.5 second per staple)
Throat depth	Adjustable approx. 3 to 23mm (1/8" to 7/8")
Dimensions	242mm (W) x 393mm (D) x 210mm (H) (9-9/16" x 15-1/2" x 8-5/16")
Weight	7.6kg (16.76 lbs)
Power source	AC100 - 240V, 50 - 60Hz
Usable staple	MAX Staple Refills No.110FE (Comes with one free staple refill.)

MAX Staple Refills No.110FE

4,000 staples/roll
(2 rolls per box)

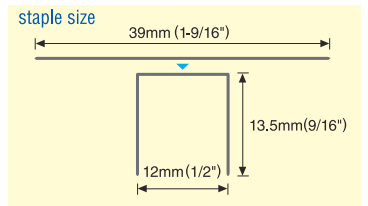

MAX Electronic stapler series

EH-20F

20 sheets
(75gsm)



MAX No.20FE
staple cartridge

Comes with one free
2,000 load staple cartridge.

EH-70F

70 sheets
(64gsm)



MAX No.70FE
staple cartridge

Comes with one free
5,000 load staple cartridge.

The specifications and design of the products in this catalogue will be subject to change without advance notice due to our continuous efforts to improve the quality of our products.



MAX CO.,LTD.

6-6,NIHONBASHI,HAKOZAKI-CHO,CHUO-KU,TOKYO,JAPAN
PHONE:81-3-3669-8131 FAX:81-3-3669-7104
Web:<http://www.max-ltd.co.jp/int/>

Distributor: